

PETRA STAR

© 2012 Maria Sinayskaya
maria@goorigami.com

VARIATION FROM 1:2 RECTANGLES

To complete the star, you will need 8 rectangles with the sides in the proportion 1:2 (e.g. 5×10 cm).

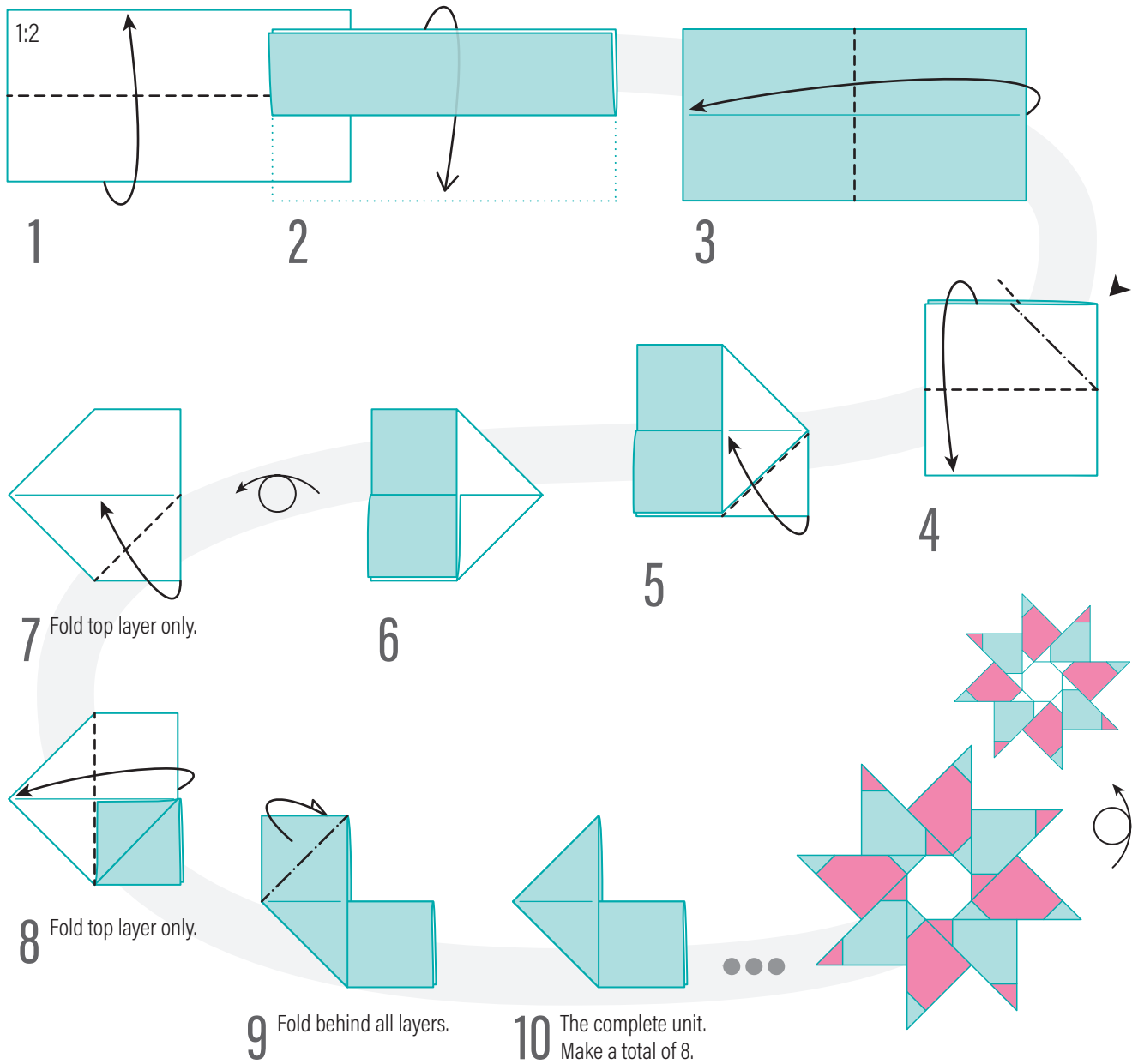

COLOR-CHANGE VARIATION

Complete up to step 7 of the basic folding sequence, then modify the unit as shown below.
Assemble in the same way as the basic model.

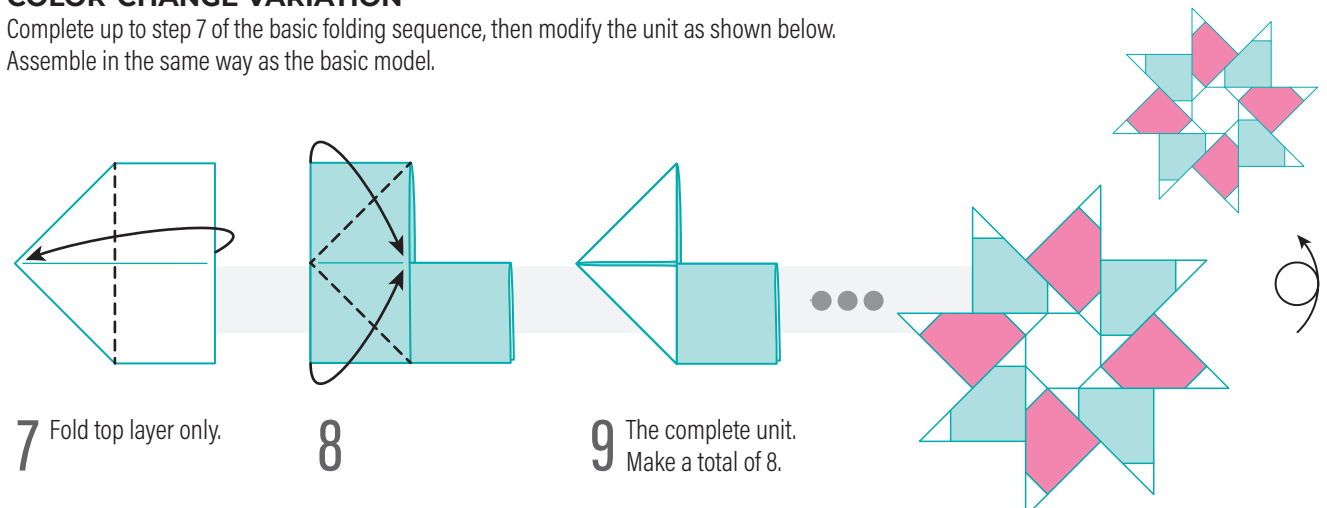

ASSEMBLY

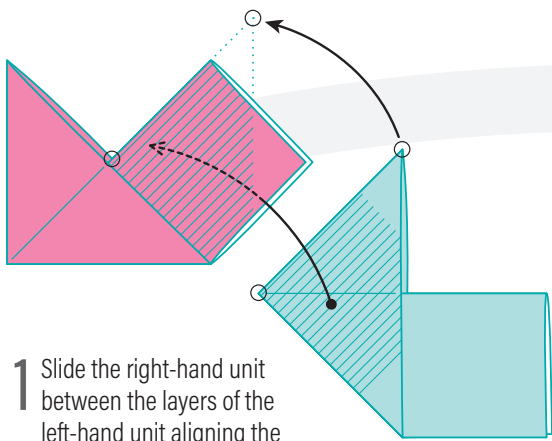

1 Slide the right-hand unit between the layers of the left-hand unit aligning the edges as shown.

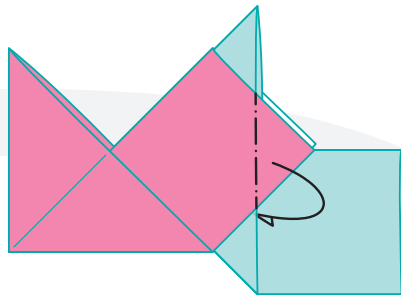

2 Mountain-fold the flap against the edge of the unit.

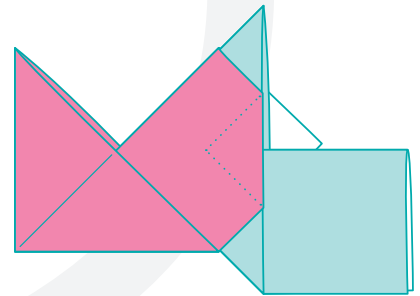

3 The result. Turn over.

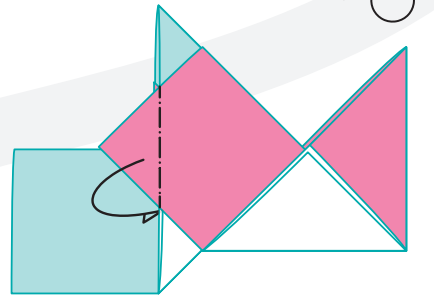
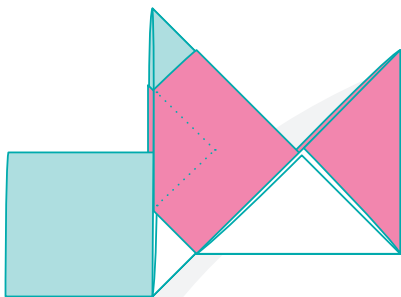

5 The result. Turn over.

4 Repeat step 2 on this side of the unit.

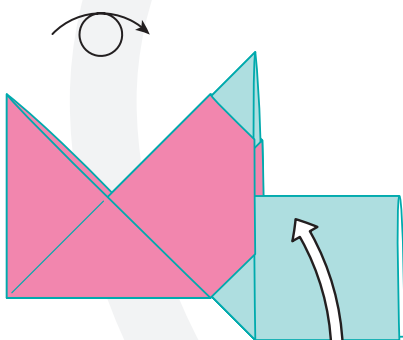

6 Continue adding more units in the same way.

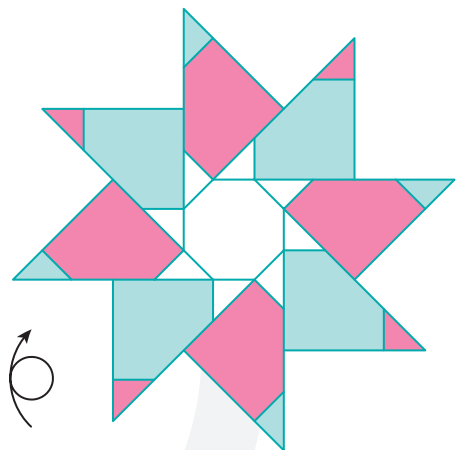
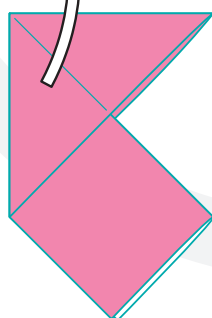

8 ... to see the other side.

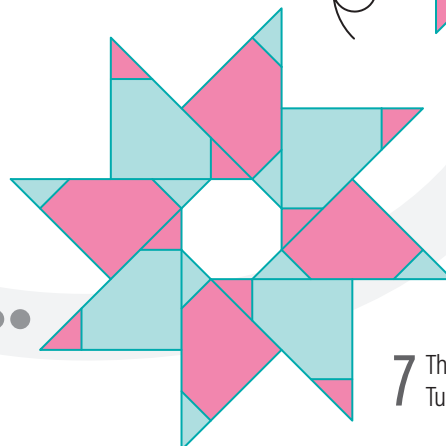

7 The complete star. Turn over...